

EST. NO.	REV LTR	REVISION	ENG	DRAFTED	APPD	DATE
G06303	A	ADDED G, H, & J3-12.	JRW	OKON	JRW	3/1/85
J55023-0	B	ADDED BLOCKS FOR LCE-06.	JCF	MJJ	MLP	10/5/86
J55023-0	C	REVISED PER AS-BUILT. ADDED BLOCKS FOR LCE-07.	MLP	OKON	MAC	6/8/84
H6C987	D	ADDED BLOCKS FOR LCE-08 & 09.	BAB	BAB	MAC	11/19/93
H8Z291	E	ADDED BLOCKS FOR LCE-10.	JEJ	JEJ	JAM	5/3/01
H4E050	6	CONVERTED TO NORTEL STANDARDS	COM	NA	NA	2/17/05

VERTICAL SIDE

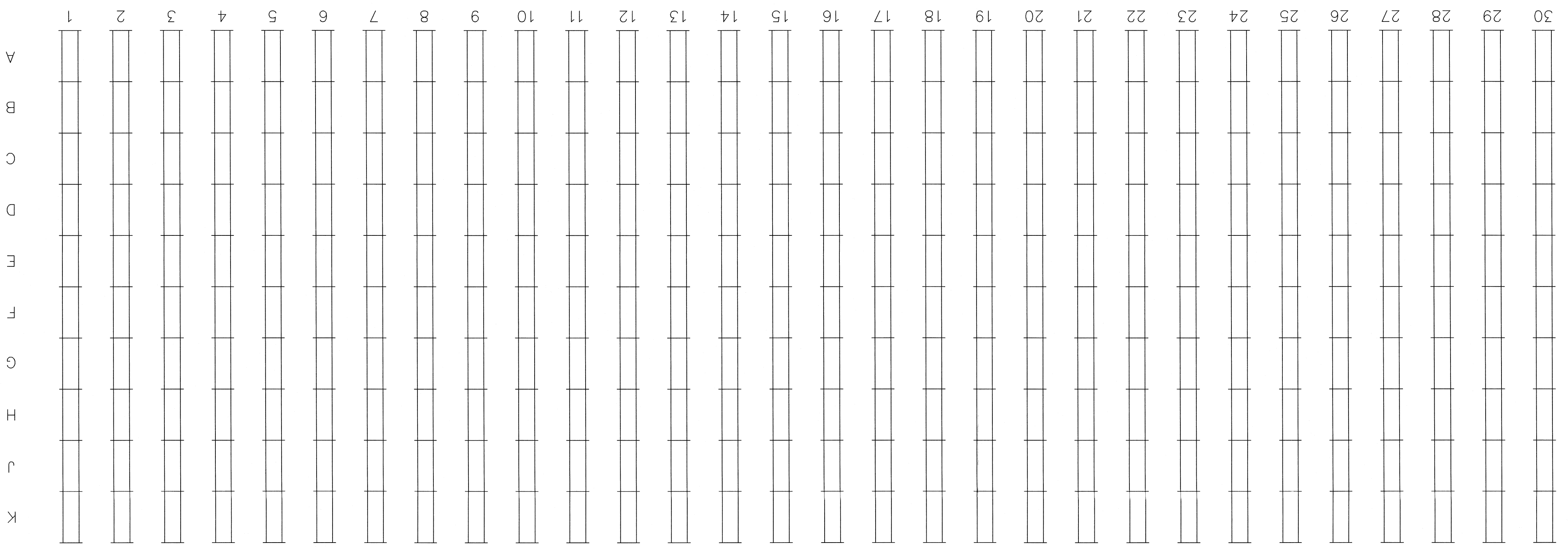

NTI SPEC:			
NTI SPEC: NA TEO#: NA CONTROL GROUP#: NA DRAWINGS HAVE BEEN CONVERTED TO AUTOCAD 2000 IN A SINGLE FILE MULTIPLE LAYOUT FORMAT. REVISION ISSUE NUMBERS ARE THE SAME FOR ALL DRAWINGS DATE: 2/17/2005			
COM	NA	NA	6
NTI SPEC: H4S922 TEO#: N/A CONTROL GROUP#: D ADDED BLOCKS TO IPEC-11 @ POS AA07 DATE: 2/7/2006			
JLT	JLT	JLT	7
NTI SPEC: H4S394 TEO#: N/A CONTROL GROUP#: D ADDED SIX 12X32C CLCE BLOCKS TO POS G18 THRU G23. DATE: 3/28/2006			
JLT	JLT	JLT	8
NTI SPEC: H5E058 TEO#: N/A CONTROL GROUP#: D ADDED 10X30WW BLOCK TO POSITION F29 FOR ALARMS DATE: 3/17/2009			
LJC	GD	IML	9

TELCO TRUNKS 10 x 30 BLOCKS BUILDING RISER CABLES

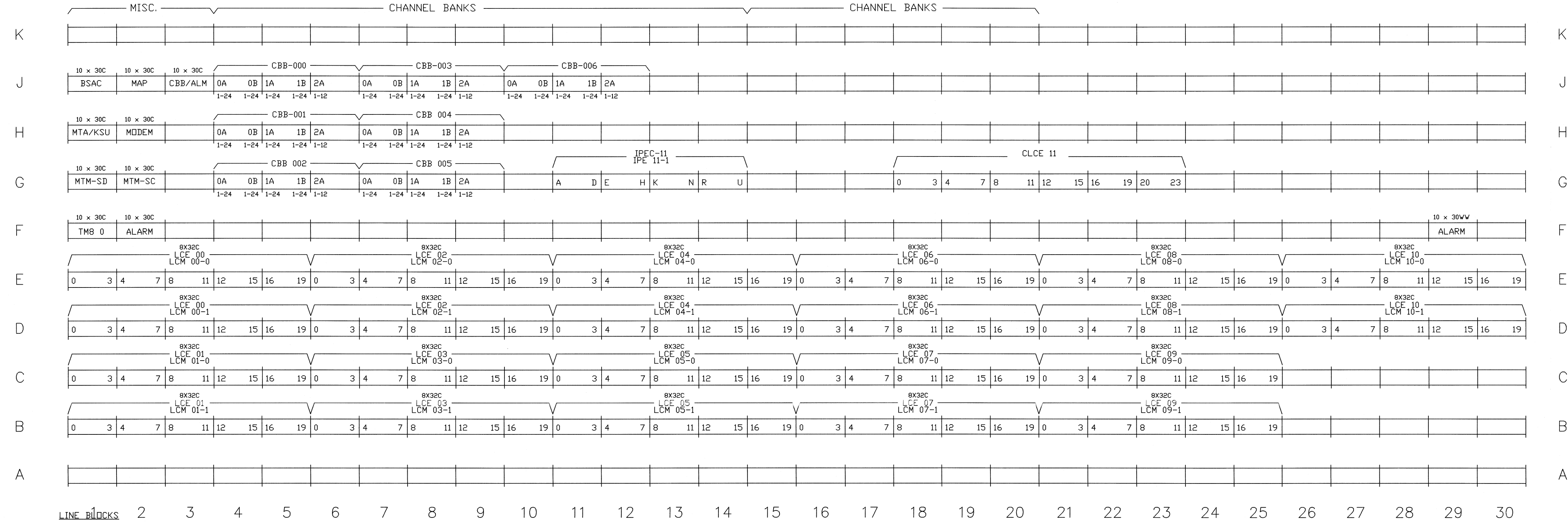

HORIZONTAL SIDE

LINE BLOCKS 2 3 4 5 6 7 8 9 10 11 12 13 14 15 16 17 18 19 20 21 22 23 24 25 26 27 28 29 30
 LCE XX - LINE BAY
 LCM XX-X - LINE MODULE
 0 3 - LSG

SHEET 1 T-S104-01-050

TUSCALAUGO		ISSUE 9	
MDF LAYOUT FIRST FLOOR SL-100 CUSTOM (EM) UNIVERSITY OF ALABAMA		SCALE 1/4"=1'-0"	
		0 2 4 6 8 SCALE IN FEET	
TUSCALOOSA, AL		T-S104-01-050	
NORTEL NETWORKS		SHEET 1	DSS

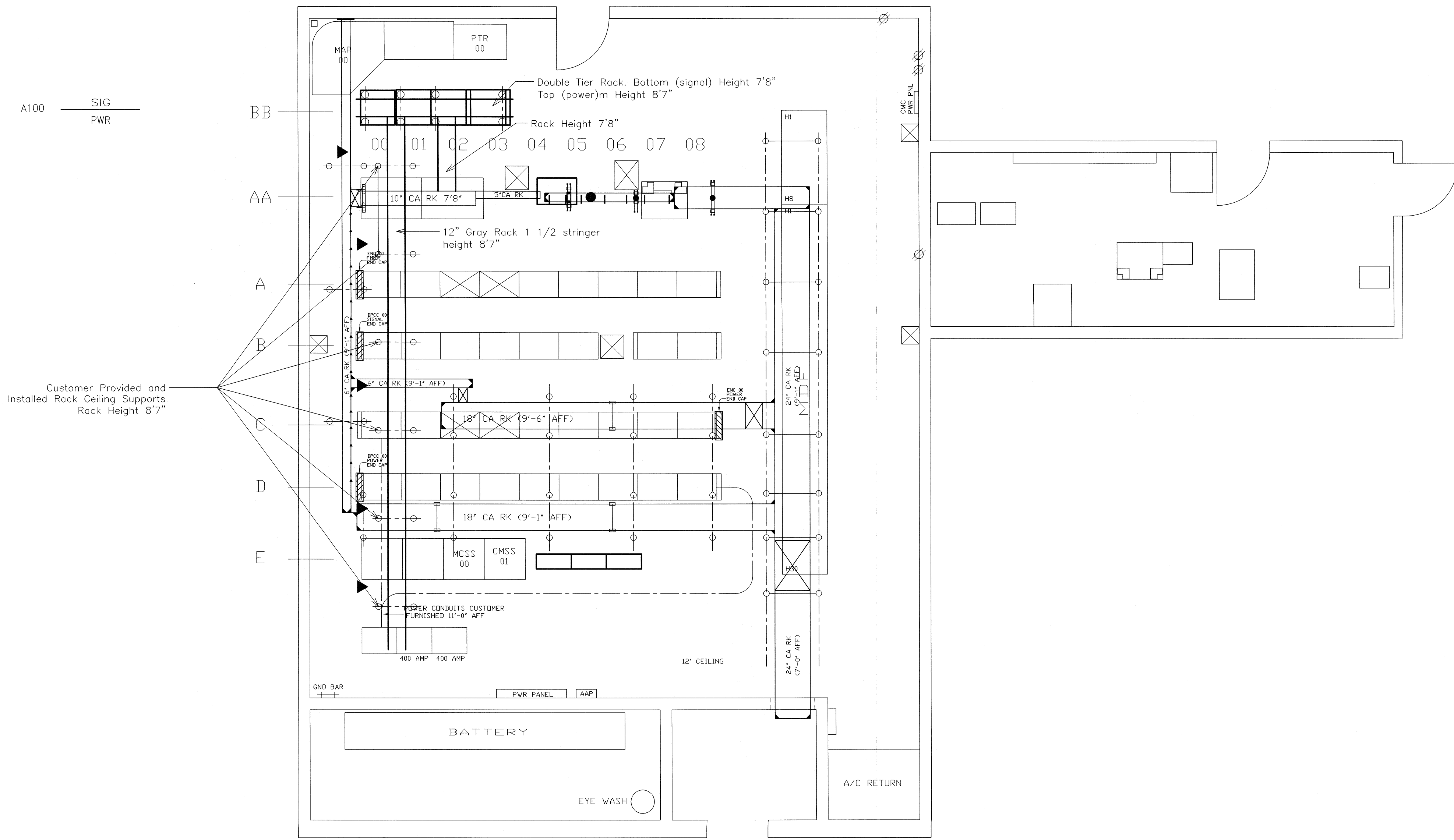
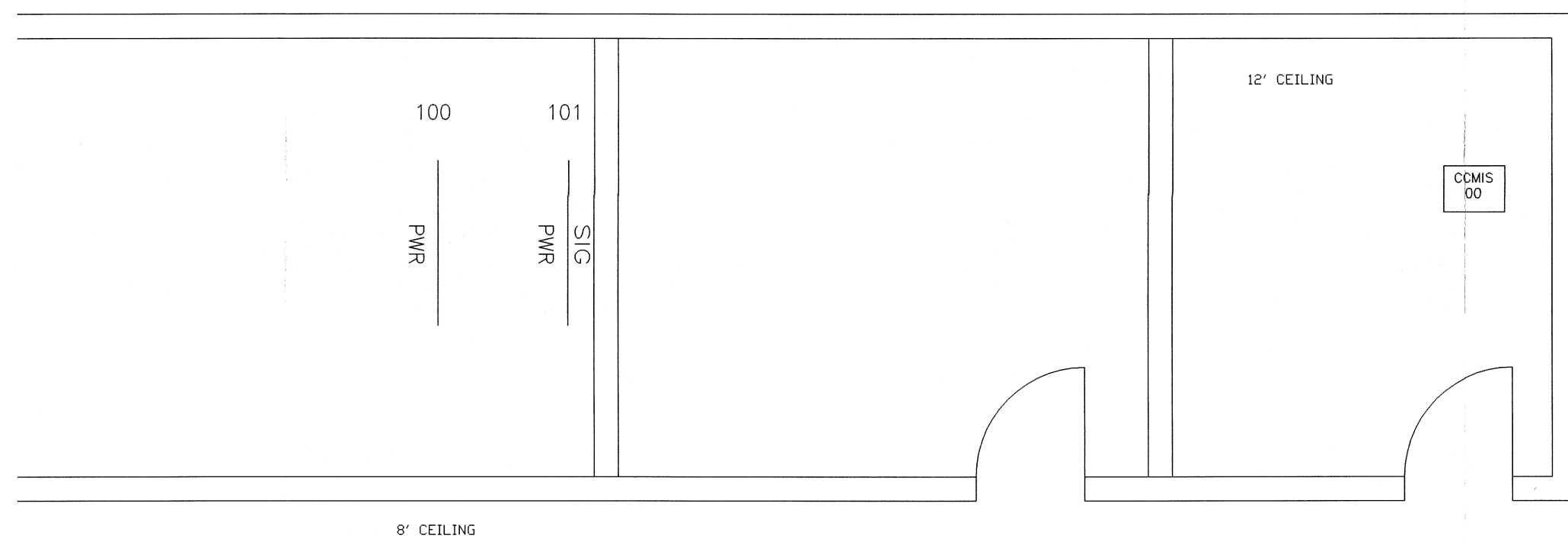

T-S104-01-601
SHEET
2

ISSUE
17

AUXILIARY FRAMING AND CABLE RACK PLAN FIRST FLOOR MSL-100 CABINET UNIVERSITY OF ALABAMA 415 Hackberry Lane TUSCALOOSA, AL		T-S104-01-601	
NORTEL NETWORKS		D	SHEETS 2
		SHEET 2	DSS

EST. NO.	REV LTR	REVISION	ENG	DRAFTED	APPD	DATE
G06303	A	DELETED FUTURE BAYS ZONE B04.	JW	OKON	JW	3/1/85
J55023-0	B	ADDED LIGHTS FOR NEW BAYS AT D06 & 07.	JCF	JOPLIN	MLP	10/5/86
J55023-0	C	ADDED LIGHTS AT C07.	MLP	OKON	MAC	12/8/88
H4E050	12	CONVERTED TO NORTEL STANDARDS	COM	NA	NA	2/17/05

CEILING OUTLET NO.	CKT. NO.	RATING	ESSENTIAL POWER	NO. OF LIGHTS		NO. OF CONV. OUTLETS	OTHER
				2'-0"	4'-0"		
(A)	-	200W	YES	-	-	4	MAP-00 (VDU) POWERED BY INV-01 IN "MS-00" BAY
(1)	1	15A	NO	-	4	-	DMS EQPT. LINE-UP A
	2	15A	NO	-	-	4	A
(2)	3	15A	NO	1	2	-	B
	4	15A	NO	-	-	4	B
(3)	5	15A	NO	2	3	-	C
	6	15A	NO	-	-	4	C
(4)	7	15A	NO	-	4	-	D
	8	15A	NO	-	-	4	D

LIGHTING NOTES:

- MODULAR LIGHTING UNITS FOR DMS FRAMES ARE INDICATED WITH DESIGNATIONS SUCH AS B-DU, B-DV, ETC. THE PREFIX "B" DENOTES ASSEMBLY DRAWING ADDX49. SUFFIXES "DU", "DV", ETC. DENOTE SPECIFIC LIGHTING UNITS AS FOLLOWS: (REVERSE) AC GND ISOLATION - LT FIXTURE ASS'YS.
 NTOX49DU (2FT)
 NTOX49DV (4FT)
 NTOX49DF (2FT) DUMMY LIGHTING UNIT
 NTOX49DG (4FT) DUMMY LIGHTING UNIT
- EACH LIGHTING CIRCUIT DOES NOT EXCEED AN ULTIMATE CAPACITY OF 12 AMP LOAD FOR EACH 15 OR 20 AMP, 120/208V SUPPLY BRANCH CIRCUIT.
 A. LINE CURRENT - .6 AMPS PER NTOX49AD-AE (2FT) LIGHTING UNIT.
 B. LINE CURRENT - .9 AMPS PER NTOX49AJ-AK (4FT) LIGHTING UNIT.
 C. LINE CURRENT - .33 AMPS PER NTOX49DU (2FT) LIGHTING UNIT.
 D. LINE CURRENT - .48 AMPS PER NTOX49DV (4FT) LIGHTING UNIT.
- END GUARD NOTES**
 MODULAR LIGHTING UNIT CONTROL SWITCHES AND APPLIANCE OUTLETS FOR DMS FRAMES ARE INDICATED WITH DESIGNATIONS SUCH AS D-DH, D-DL, ETC. THE PREFIX "D" DENOTES ASSEMBLY DRAWING ADDX07. SUFFIXES "DH", "DL", ETC. DENOTE SPECIFIC AC HARDWARE AND ELECTRICAL EQUIPMENT AS FOLLOWS: (REVERSE) AC GND ISOLATION HARDWARE FOR FRAME COMMON ASS'YS.
FIRST FRAME WITH AC OUTLET
 NTOX07DH 0 SWITCH WITH AC
 NTOX07DL 1 SWITCH WITH AC
 NTOX07DG 2 SWITCH WITH AC
LAST FRAME WITH AC OUTLET
 NTOX07DK 0 SWITCH WITH AC
 NTOX07DM 1 SWITCH WITH AC
 NTOX07DJ 2 SWITCH WITH AC
FIRST FRAME WITHOUT AC OUTLET
 NTOX07DB 0 SWITCH NO AC
 NTOX07DE 1 SWITCH NO AC
 NTOX07DA 2 SWITCH NO AC
LAST FRAME WITHOUT AC OUTLET
 NTOX07DF 0 SWITCH NO AC
 NTOX07DF 1 SWITCH NO AC
 NTOX07DC 2 SWITCH NO AC
AC AROUND COLUMN
 NTOX07AZ
BASE OF ANY FRAME WITH AC OUTLET
 NTOX07DY - BASE MOUNTED AC OUTLET

- ALL AC CIRCUITS, CONDUITS, AND SQUARE-D DUCTS ARE IN ACCORDANCE WITH N.E.C. FOR SIZE AND NUMBER OF CONDUCTORS.
- NUMBERS IN PARENTHESIS () INDICATE BRANCH CIRCUIT NUMBERS.
- ⊗ - DENOTES CEILING OUTLET BOX WITH ESSENTIAL POWER (SEE TABLE A).
- - DENOTES CEILING OUTLET BOX WITH NON-ESSENTIAL POWER (SEE TABLE A).
- ⊠ - DENOTES POWER POLE WITH ESSENTIAL POWER (SEE TABLE A).
- - DENOTES POWER POLE WITH NON-ESSENTIAL POWER (SEE TABLE A).
- ⌞ - DENOTES LOW INTENSITY LIGHTING MODULE.
- + - DENOTES FRAME AISLE LIGHT SWITCH MOUNTED ON END GUARD OR LOW INTENSITY LIGHTING SWITCH MOUNTED ON WALL OR COLUMN.

NTI SPEC:			
COM	NA	NA	12
NTI SPEC: H4N721 TEO#: N/A CONTROL GROUP#: D ADDED IPEC 00 AT A 07 AND CALL PILOT NEXT TO MMGP. DATE: 2/28/2005			
DMC	BJJ	NSTR	13
NTI SPEC: H4S922 TEO#: N/A CONTROL GROUP#: D ADDED 2ND MOD. & BLOCKS FOR IPEC 11 AND CABLE RK FROM IPEC 11 TO MDF. DATE: 2/10/2006			
JLT	JLT	IML	14
NTI SPEC: H4S366 TEO#: N/A CONTROL GROUP#: D ADDED MCAM 00 @ POS E00, PXAC 00 @ POS AA 04 AND MOVE MCSS 00 FROM POS AA 04 TO E02. DATE: 3/24/2006			
JLT	JLT	IML	15
NTI SPEC: H4S394 TEO#: N/A CONTROL GROUP#: D ADDED CLCE 11 @ POS E01 AND CMSS 00 @ POS AA04. DATE: 3/24/2006			
JLT	JLT	IML	16
NTI SPEC: H5E058 TEO#: TBD CONTROL GROUP#: D ADD CSF 00 COAM 00, PT2K 00 SPME 00 AND SPDC 00 DATE: 11/13/2008			
MGF	MGF	2401	17

SHEET 1
T-S104-01-603

TSCLLAUCGO		SCALE 1/4"=1'-0"		ISSUE 17	
LIGHTING PLAN		0 2 4 6 8		SCALE IN FEET	
FIRST FLOOR					
MSL-100 CABINET					
UNIVERSITY OF ALABAMA					
415 Hackberry Lane					
TUSCALOOSA, AL					
NORTEL NETWORKS		D		SHEETS 2	
SHEET 1		DSS			
T-S104-01-603					

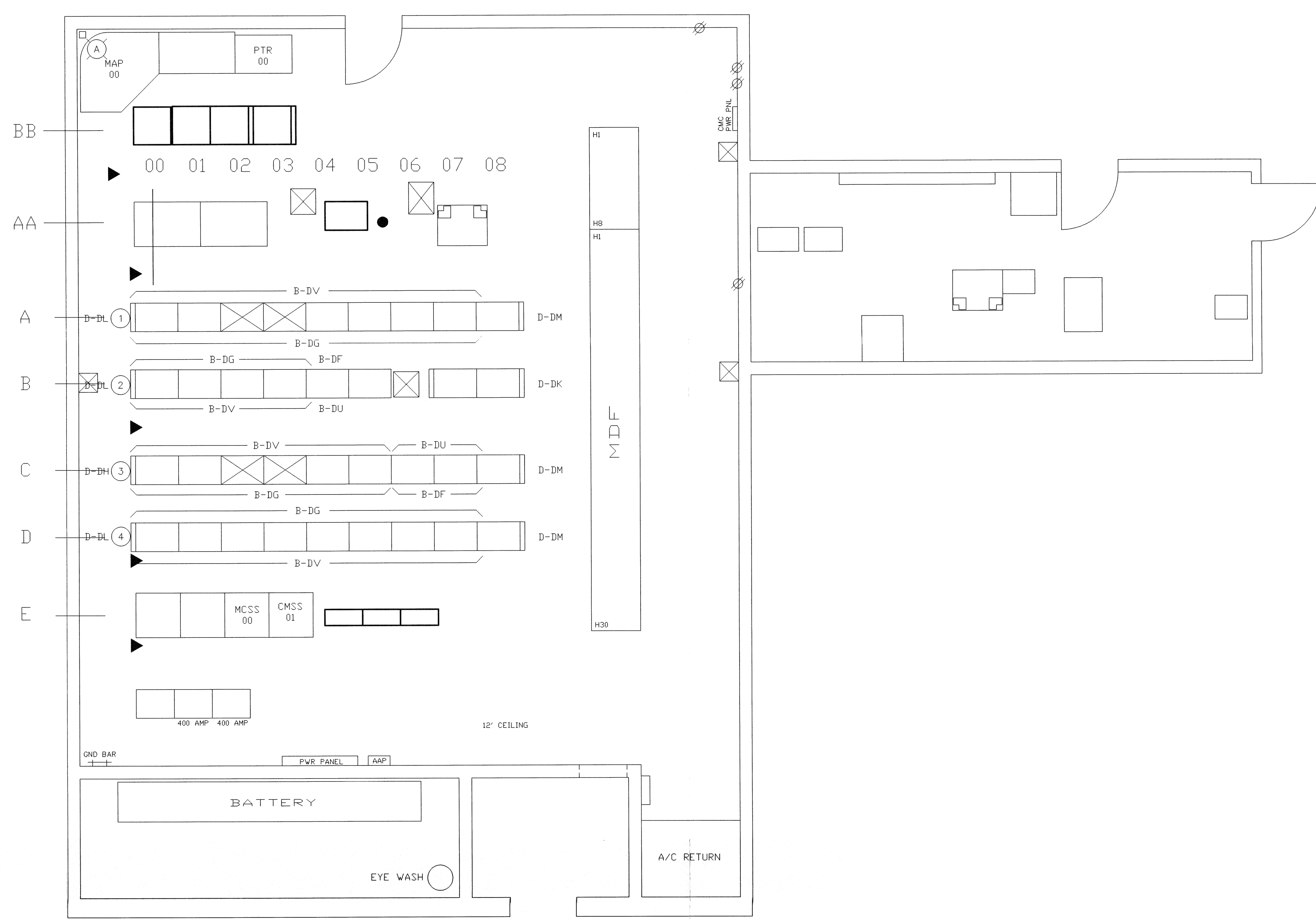
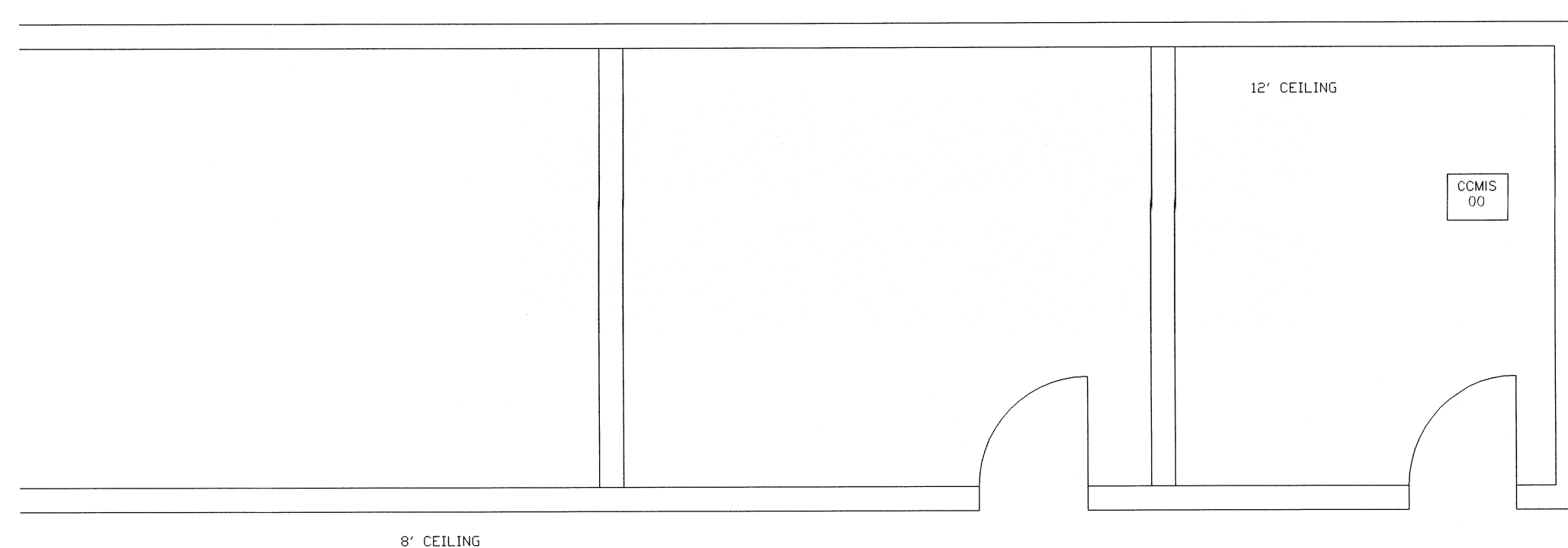

T-S104-01-603
SHEET 2

ISSUE
17

LIGHTING PLAN FIRST FLOOR MSL-100 CABINET UNIVERSITY OF ALABAMA 415 Hackberry Lane TUSCALOOSA, AL		T-S104-01-603	
	D	SHEETS 2	SHEET 2
			DSS

TABLE 1	
(TERMINATION OR SIZE OF LEAD) SEE NOTES:	
(A)	750,000 CM INSL
(B)	350,000 CM INSL
(C)	NO. 4/0 AWG INSL
(D)	NO. 2/0 AWG INSL
(E)	NO. 1/0 AWG INSL
(F)	NO. 2 AWG INSL
(G)	NO. 4 AWG INSL
(H)	NO. 6 AWG INSL
(J)	NO. 10 AWG INSL

T-S104-01-650 SHEET 1

ISSUE
17

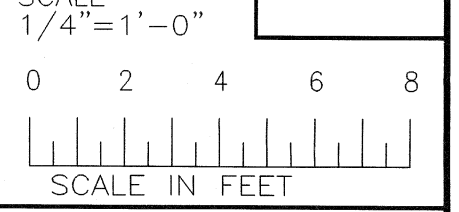

xxxx
 GROUNDING SCHEMATIC
 FIRST FLOOR
 MSL-100 CABINET
 UNIVERSITY OF ALABAMA

415 Hackberry Lane
 TUSCALOOSA, AL

T-S104-01-650

NORTEL NETWORKS 6S SHEETS 2

SHEET	DSS
1	

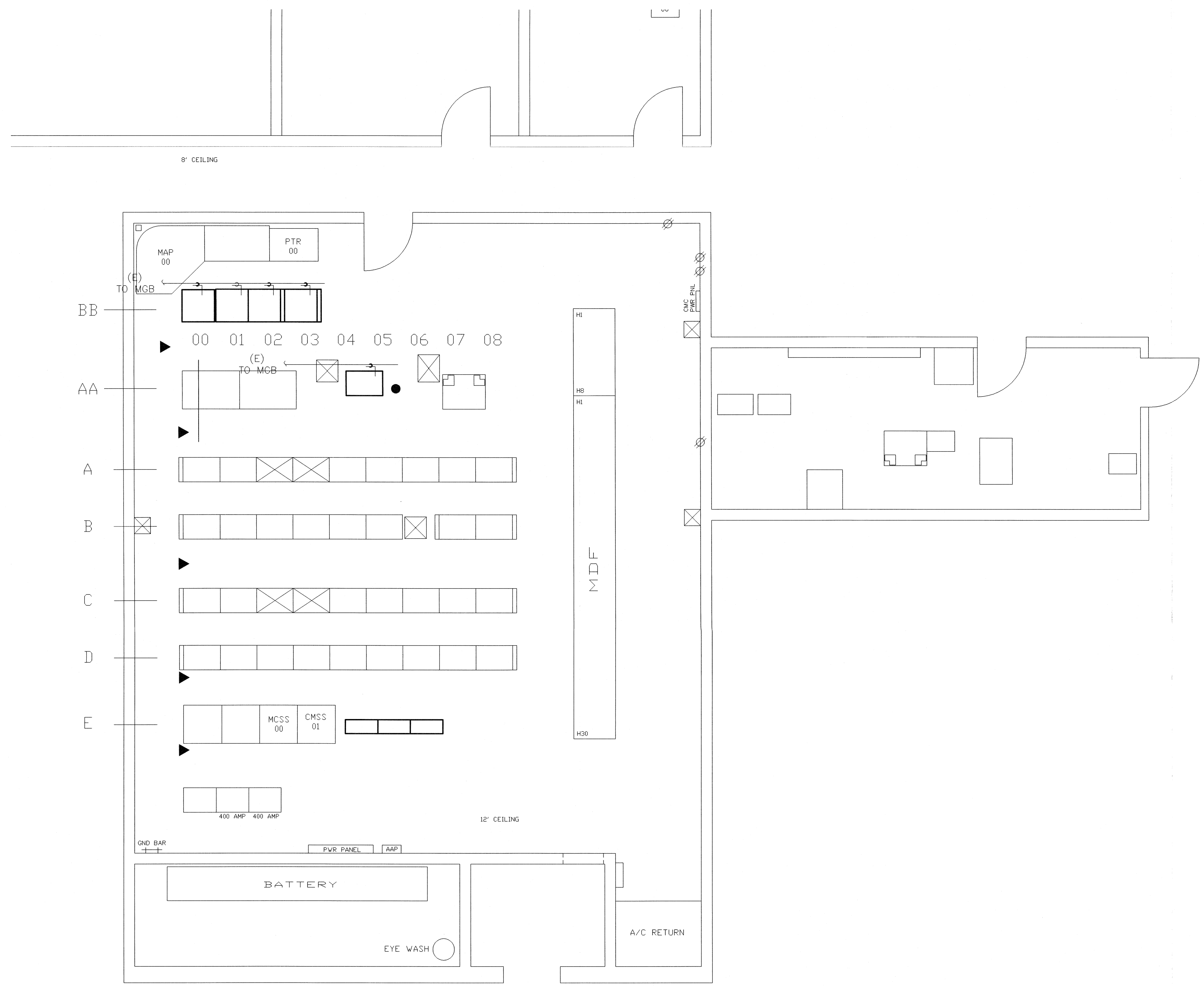

T-S104-01-650
SHEET
2

ISSUE
17

GROUNDING SCHEMATIC FIRST FLOOR MSL-100 CABINET UNIVERSITY OF ALABAMA 415 Hackberry Lane TUSCALOOSA, AL		T-S104-01-650	
	6S	SHEETS 2	SHEET 2
			DSS